

### SPECIFICATIONS

- Type: 868MHz / 915MHz
- Size: 18\*13.8\*3mm
- Weight: 0.9g (w/o antenna)
- MCU: ESP8285
- RF Chip: SX1276
- Refresh rate: 25Hz ~200Hz
- Input Voltage: 5V
- Antenna Connector: U.F.L
- Receiver protocol: CRSF
- Telemetry Power: max. 500mw
- Firmware (pre-installed): ExpressLRS v3.0

### INCLUDES

- 1x BR1 ELRS 900MHz Receiver
- 1x 75mm U.F.L 900MHz T/Y Antenna
- 1x User Manual Card
- 4x Silicone wires

### DEFAULT FIRMWARE

RadioMaster BR1 900 RX

For more information, please visit the ELRS website:  
<https://www.expresslrs.org/2.0/>

### CONFIGURATION

Identifier	Configuration/MSP	Serial RX
USB VCP	<input checked="" type="checkbox"/> 115200	<input type="checkbox"/>
UART1	<input type="checkbox"/> 115200	<input type="checkbox"/>
UART2	<input type="checkbox"/> 115200	<input checked="" type="checkbox"/>

Open **Betaflight** Configurator, go to **Ports** tab and enable the corresponding UART as a Serial RX (e.g. UART2 as shown above) **Save** and **Restart**.



On the **Configuration** tab, click on **Serial-based receiver** on the **Receiver** panel, and select **CRSF**.

### TRADITIONAL BINDING

Binding Phrase field must be uncommented in **Device options** on the RX.

1. Power **OFF** your transmitter/radio.
2. Plug in and unplug your receiver **3 times**.
3. Make sure the LED is doing a quick **double blink**, which indicates the receiver is in bind mode.
4. Power **ON** your transmitter/radio and use the [BIND] button on the ExpressLRS Lua script, which sends out a binding pulse.
5. If the receiver has a **solid light**, it's bound!

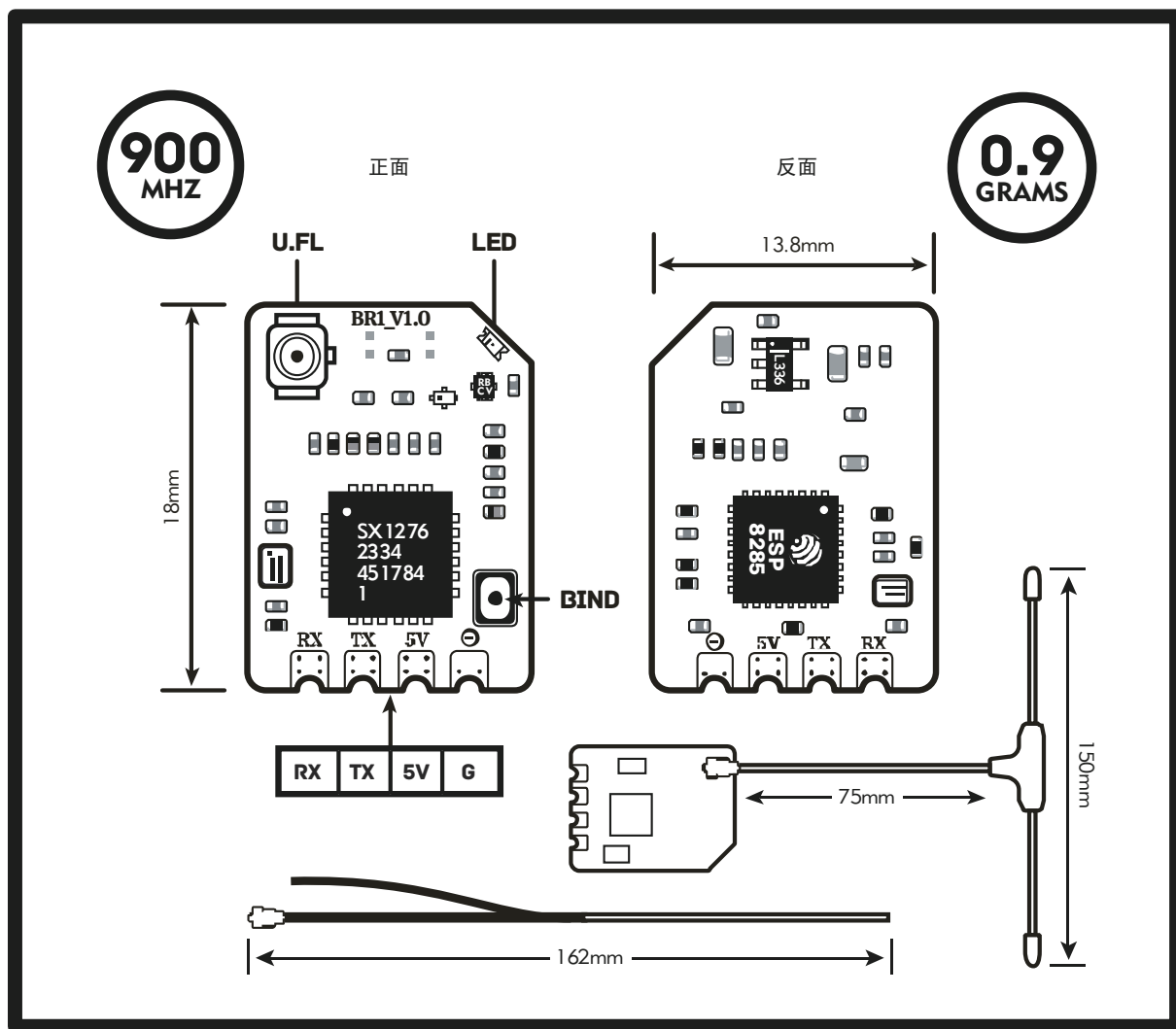

### 规格参数

- 频段类型: 868MHz / 915MHz
- 尺寸: 18\*13.8\*3mm
- 重量: 0.9g (w/o antenna)
- MCU: ESP8285
- 射频芯片: SX1276
- 刷新率: 25Hz~200Hz
- 输入电压: 5V
- 天线: U.F.L
- 总线接口: CRSF
- 回传功率: 最大50mw
- 无线协议: ExpressLRS v3.0

### 包装清单

- 1x BR1 ELRS 900MHz 接收机
- 1x 75mm U.F.L 900MHz T/Y 天线
- 1x 服务卡
- 4x 连接线

### 固件下载

RadioMaster BR1 900 RX

For more information, please visit the ELRS website:  
<https://www.expresslrs.org/2.0/>

### 设置

Identifier	Configuration/MSP	Serial RX
USB VCP	<input type="checkbox"/> 115200	<input type="checkbox"/>
UART1	<input type="checkbox"/> 115200	<input type="checkbox"/>
UART2	<input type="checkbox"/> 115200	<input checked="" type="checkbox"/>

打开Betaflight Configuration, 转到Ports端口选项卡并启用相应的UART作为Serial RX (例如, 如上所示的UART2) 保存并重新启动。

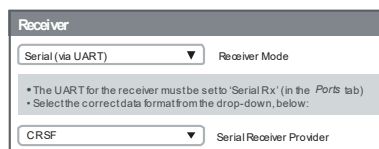

在Configuration选项卡上, 单击Receiver面板上的Serial-based receiver, 并选择CRSF。

### 对频方法

- 1: 关闭遥控器
- 2: 重复给接收机上电三次, 接收机灯双闪, 表明接收机处于对频模式
- 3: 开启遥控器, 进入ExpressLRS的LUA操作界面, 选择到【BIND】按键确认
- 4: 接收机灯常亮表明对频成功